

PLAN

SEE FRAME AND COVER DETAILS ON THIS SHEET

BACKFILL SHALL BE TYPE II SLURRY

V.C.P. (SAME SIZE AS THAT OF THE SEWER TRUNK)

6" MINIMUM ENCASEMENT

12" DIAMETER OR LESS

DRY PACK

SEE STANDARD DRAWING NO. 2001 FOR MANHOLE CONSTRUCTION ①

VARIES

6" MIN

6" MIN.

SHELF CHANNEL

0.20' MIN. DROP

#4@4"

CONCRETE SUPPORT CLASS 560-C-3250 PER SECTION 201-1.1.2 STANDARD SPECIFICATIONS FOR PUBLIC WORKS CONSTRUCTION

SECTION VIEW

CAP W/ BAND SEAL CLAMP FOR NON-PRESSURE SYSTEM. BLIND FLANGE W/BOLTS & NUTS FOR PRESSURE SYSTEM

NON PRESSURE SYSTEMS TCO

PRESSURE SYSTEMS TCO(P)

AC OR CONC PAVEMENT

1" MIN

CI FRAME & COVER

PIPE

3000 PSI CONC ENCASEMENT 2'-0"x 2'-0"x1'-6" (LXWXD) OR 2'-0"Øx1'-6"

NOTES

- ① DROP MANHOLES SHALL BE CONSTRUCTED WITH A 60" INSIDE DIAMETER.
- ② ALL NEW OPENINGS CONSTRUCTED INTO MANHOLE SHALL BE CORE DRILLED.
- ③ A 24" LONG STUB SHALL BE INSTALLED FROM THE MANHOLE INSIDE WALL TO THE PIPE BELL.
- ④ DROP MANHOLES ONLY ALLOWED WITH SPECIAL CONSIDERATION BY CITY.

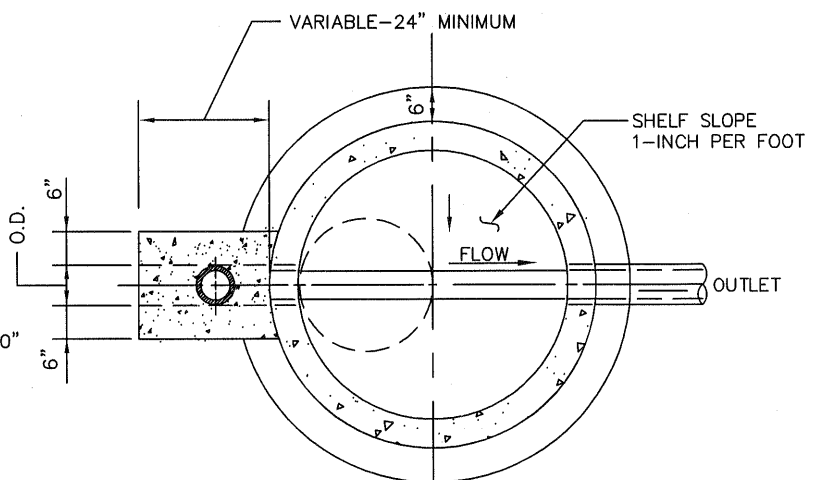

PLAN



APPROVED BY:		24079 08/15/06	
JOHN P. SULLIVAN CITY ENGINEER		RCE DATE	
RECOMMENDED:		57875 08/14/06	
ASST. UTIL. DIRECTOR/ENG.		RCE DATE	
REV	DESCRIPTION	BY	APP'D DATE

CITY OF ONTARIO

DROP MANHOLE FOR 12" VCP OR LESS

STANDARD DRAWING NUMBER

2002