

PLAN

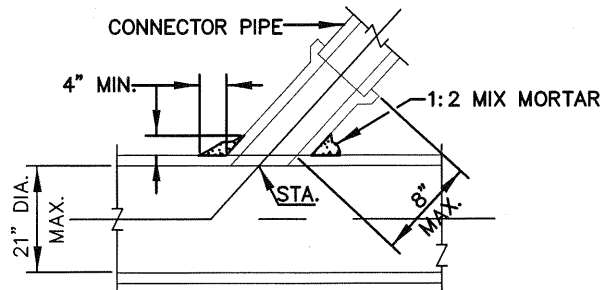

SECTION D-D

NOTES: CASE 3

- ① CONNECTIONS TO PIPES 21" OR LESS IN DIAMETER WITHOUT JUNCTION STRUCTURES OR PRECAST Y BRANCHES SHALL BE MADE WITH SADDLES.
- ② TRIM OR CUT SADDLE TO FIT SNUGLY OVER THE OUTSIDE OF THE MAIN PIPE, AND SO ITS AXIS WILL BE ON THE LINE AND GRADE OF THE CONNECTING PIPE.
- ③ THE OPENING INTO THE PIPE SHALL BE CUT AND TRIMMED TO FIT THE SADDLE SO THAT NO PART WILL PROJECT WITHIN THE BORE OF THE SADDLE PIPE.
- ④ THE CONNECTING PIPE SHALL BE SUPPORTED AS SHOWN IN CASES 1 AND 2.

CASE 3
SADDLE CONNECTION



APPROVED BY: <i>John P. Sullivan</i> 24079 8/08/06				
JOHN P. SULLIVAN CITY ENGINEER RCE DATE				
RECOMMENDED: <i>John Min March</i> 33340 8/07/06				
ASSISTANT CITY ENGINEER RCE DATE				
REV	DESCRIPTION	BY	APP'D	DATE

CITY OF ONTARIO

JUNCTION STRUCTURE
NO 1

CASE 3 SADDLE CONNECTION

STANDARD
DRAWING
NUMBER

3011